

# meet our neighbours

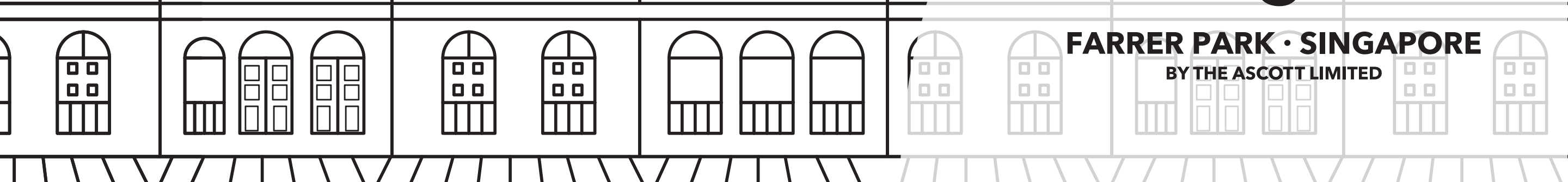
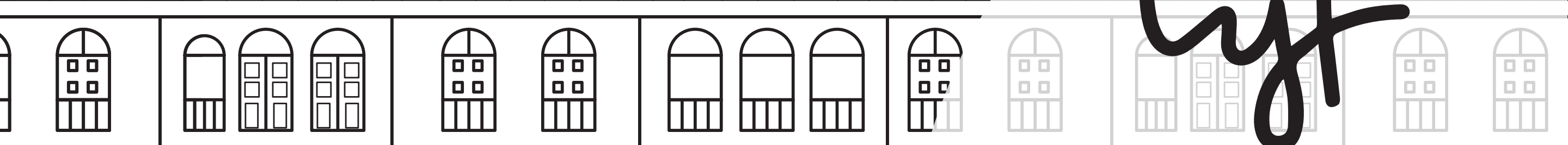
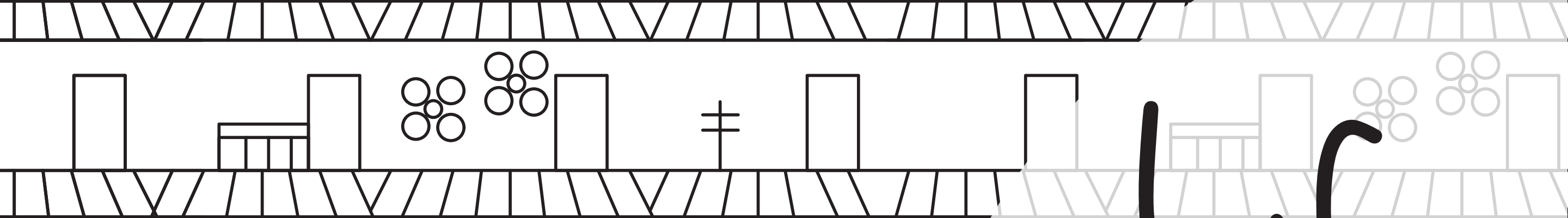
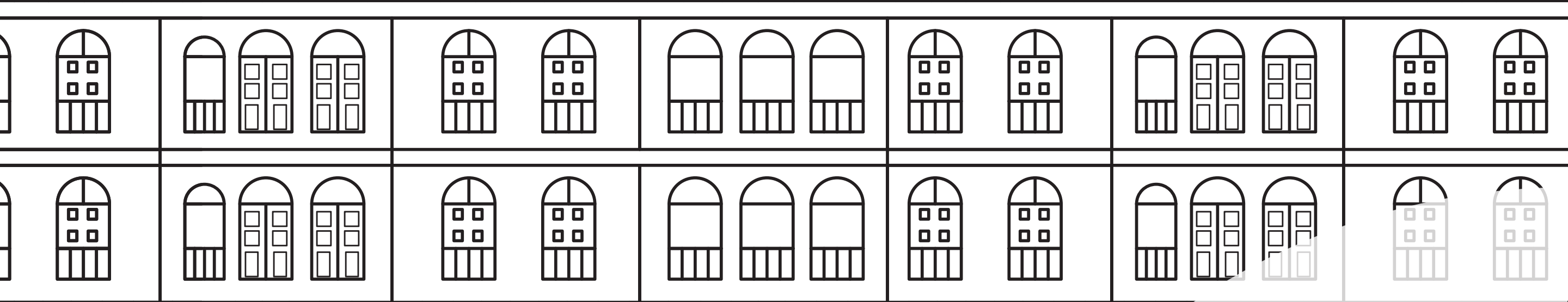
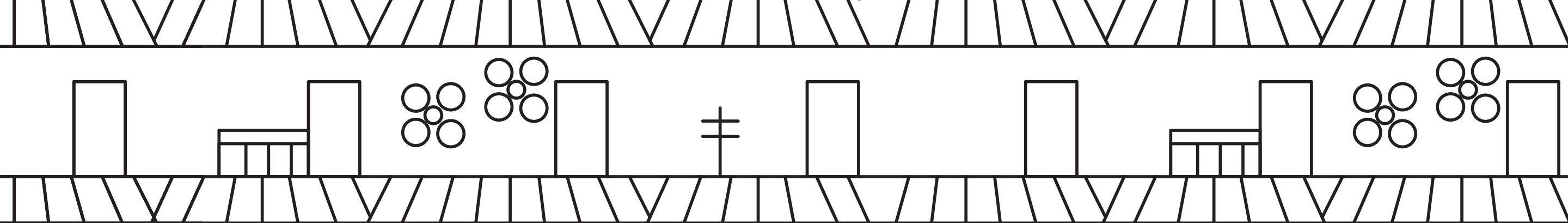
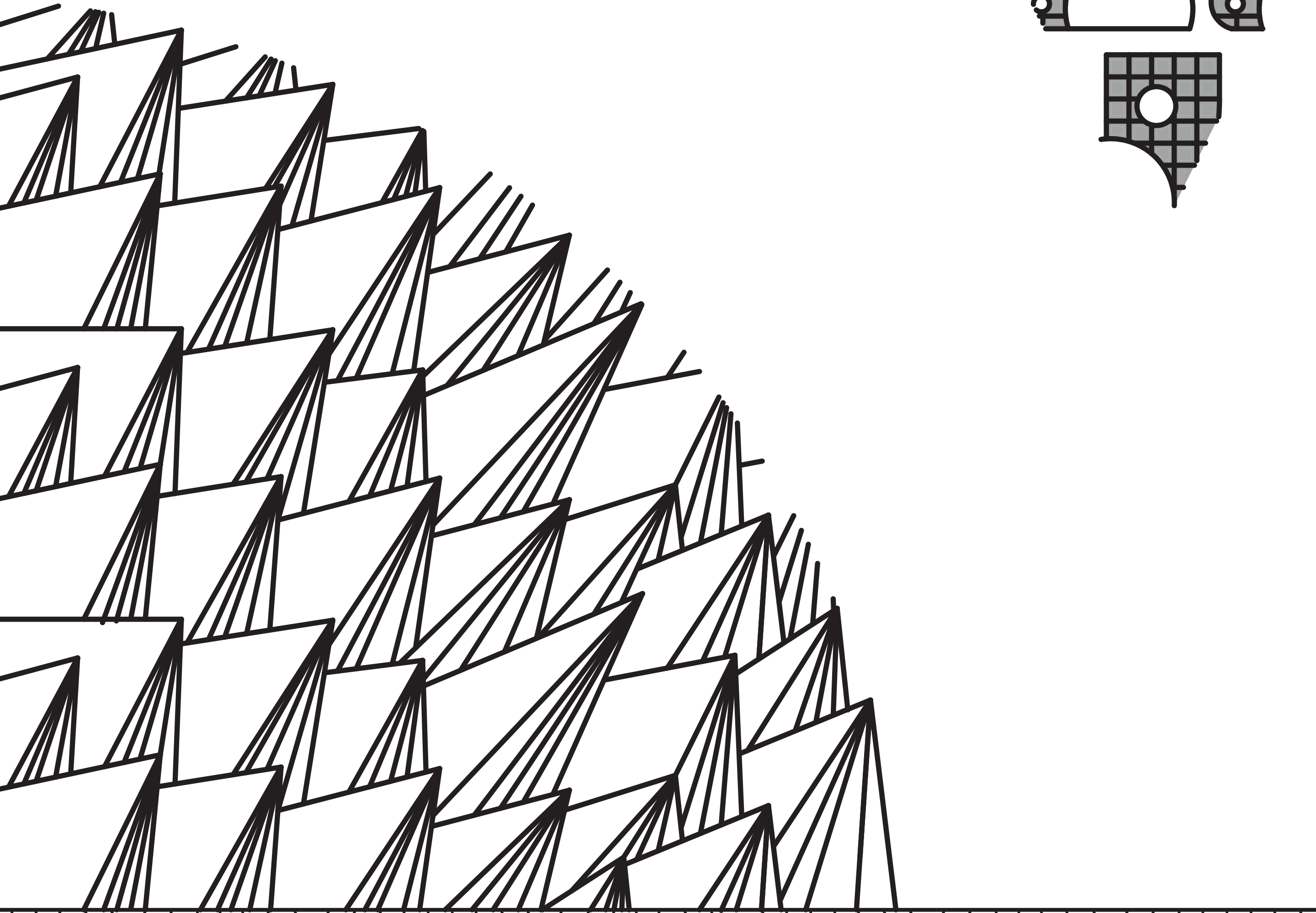
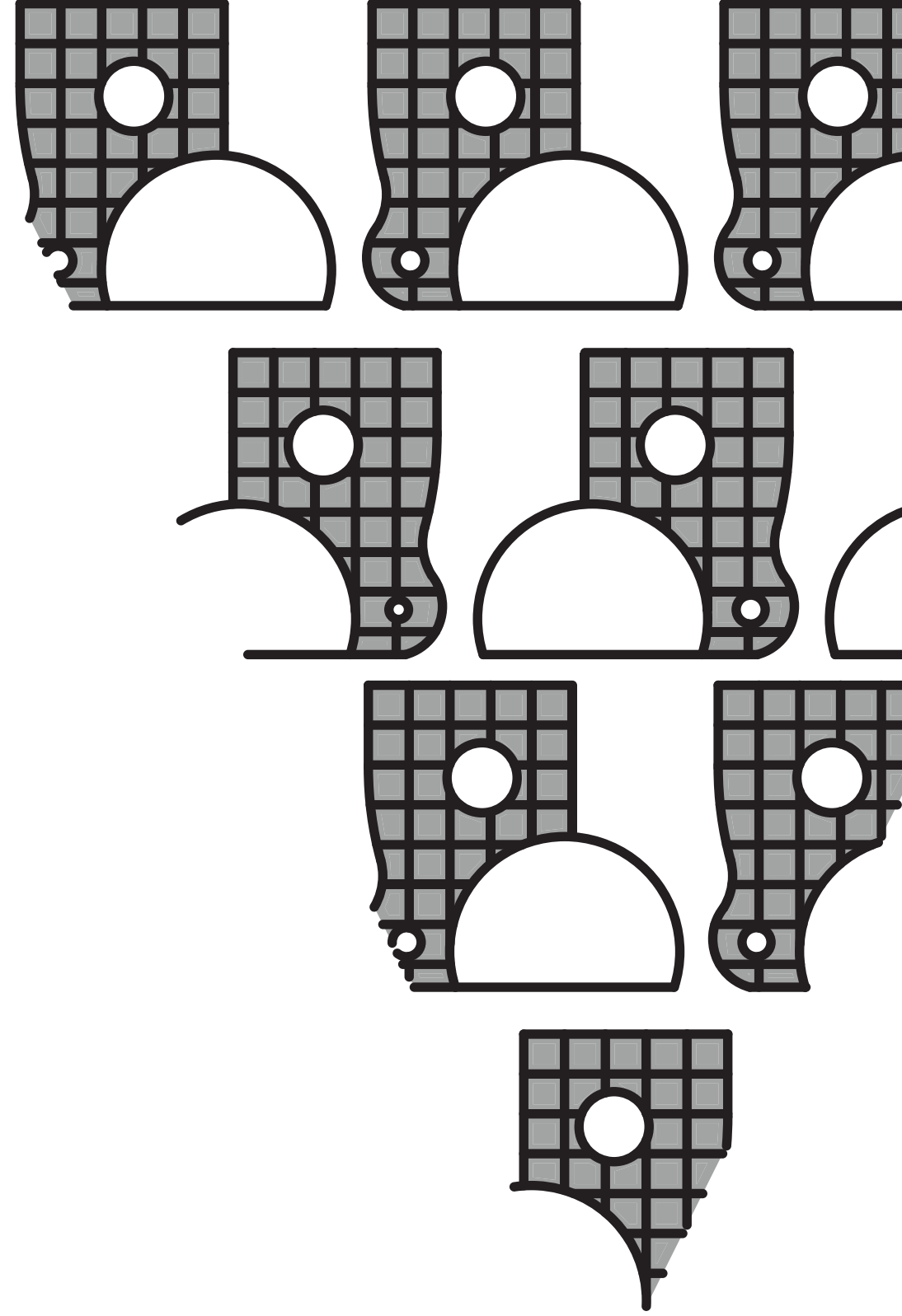

**FARRER PARK · SINGAPORE**  
BY THE ASCOTT LIMITED

**Located at  
the heart of  
Singapore's  
ethnic enclave,  
come experience  
a side of  
Singapore like  
no other at  
lyf Farrer Park  
Singapore.**

Nostalgic, multi-faceted and vibrantly youthful all at once, Farrer Park's vibe inspires both wonder and discovery. Awaken your senses and plunge into these experiences either by foot or via Farrer Park MRT just a stone's throw away.

**Discover all things local within the vicinity of lyf Farrer Park Singapore** in this specially curated guide, created for three types of travellers:

- First Timers
- Culture Pushers
- Gastronomers

Whether you're a lover of heritage sites, lesser-known indie entertainment venues, or iconic food haunts, your unforgettable journey around Singapore begins here. Slather on the sunscreen and grab your power banks—let's get started!

---

#### NEED A RIDE?

Download Grab from the App Store →  
or Google Play → for fuss-free journeys  
around the city!

# first timers

New here? Embark on the quintessential Singaporean adventure of sights, sounds and sensations most familiar to the locals. Filled with a dynamic blend of food, art, nature and heritage, you'll be living like a local by the end of it!

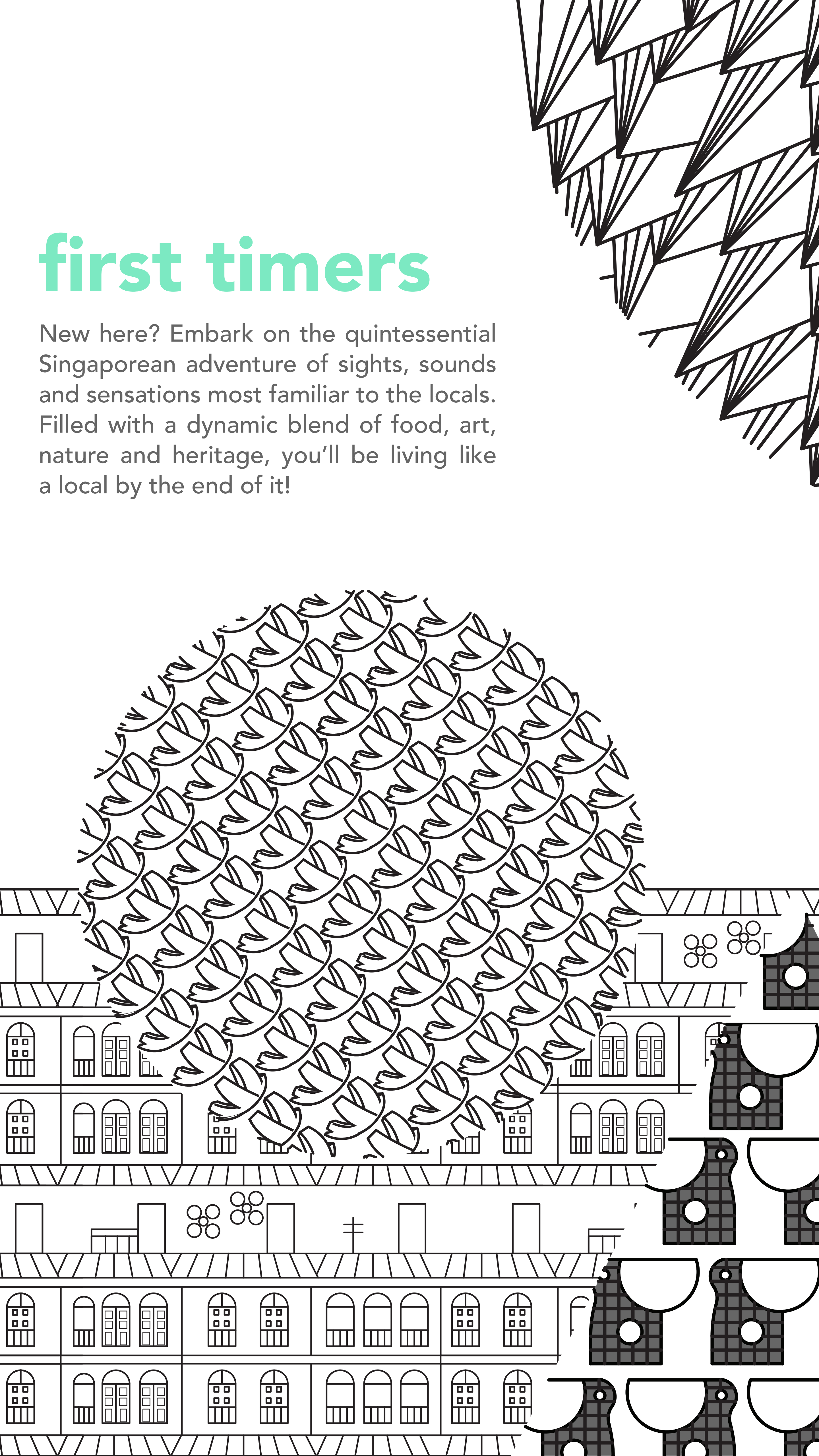

450m

## Planet Bowl

\$\$

Gather (not gutter...) your friends and family and have a friendly competition to see who makes the first strike! Bring your "A-game" and knock out those pins like a pro.

---

**ADDRESS**

60 Tessensohn Rd  
Singapore 217664

---

**OPENING HOURS**

Sunday to Thursday: 10am – 11pm  
Friday: 10am – 1am  
Saturday: 9am – 1am

---

**CONTACT**

6391 5693

---

**WEBSITE**

[www.csc.sg/planetbowl/](http://www.csc.sg/planetbowl/)

450m

## Ground Up Climbing

\$\$

Hit the ground running by taking on an upscale battle on the rocks as you enjoy a nearby climbing session with your pals! Get those palms chalked up and slip on your climbing shoes as you are in for a rocky battle.

---

**ADDRESS**

60 Tessensohn Road  
CSC@Tessensohn Level 2  
Singapore 217664

---

**OPENING HOURS**

Monday: 5pm – 11pm  
Tuesday to Thursday: 11am – 11pm  
Friday: 11am – 10.30pm  
Saturday and Sunday: 10am – 8pm

---

**CONTACT**

6292 7701

---

**WEBSITE**

[www.groundupsg.com](http://www.groundupsg.com)

450m

## Hilltop Academy

\$\$

Sawasdee! Lace up and get those straps tightened for a grueling Muay Thai session. Get ready to be knocked around and dripping in sweat. Don't say we didn't warn you!

---

**ADDRESS**

576B Serangoon Rd, Level 3  
Singapore 218190

---

**OPENING HOURS**

Sunday: Closed  
Monday to Friday: 2pm – 9.30pm  
Saturday: 9am – 5.30pm

---

**CONTACT**

9151 6537

---

**WEBSITE**

[www.hilltopacademysg.com](http://www.hilltopacademysg.com)

650m

## Parkour Gym Singapore – Free Runner Lodge – A2 Parkour

\$

Want to learn the arts of parkour and free running? Visit this gym and get ready for some flipping fun action and excitement! Get in touch with your inner Spiderman and show off your new moves to your pals!

---

**ADDRESS**

261 Lavender St, #01-01  
Singapore 338794

---

**OPENING HOURS**

Open daily: 12pm – 10pm

---

**CONTACT**

9184 9744

---

**WEBSITE**

[www.a2movements.com](http://www.a2movements.com)

400m

## Mustafa Centre

\$\$

Find just about anything and everything at Mustafa Centre. Be spoilt for choice as the mall offers fresh groceries, apparels, electronics and many more!

**ADDRESS** 145 Syed Alwi Rd, Mustafa Centre  
Singapore 207704

**OPENING HOURS** Open daily: 9.30am – 11.30pm

**CONTACT** 6295 5855

**WEBSITE** [www.mustafa.com.sg](http://www.mustafa.com.sg)

550m

## F45 Training Farrer Park

\$

Get ready for a sweat sesh! F45 isn't kidding about their high intensity trainings. Join the community and get fit together today. Watch yourself grow physically and mentally as F45 trainers are known to continuously push you to your limits!

**ADDRESS** 18 Sam Leong Rd  
Singapore 207909

**OPENING HOURS**

Monday:	6am – 9am 12.15pm – 2pm 5pm – 9pm
Tuesday to Thursday:	6am – 10am 12.15pm – 2pm 5pm – 9pm
Friday:	6am – 9am 12.15pm – 2pm 5pm – 9pm
Saturday:	8am – 2pm
Sunday:	8am – 1pm

**CONTACT** 8748 6673

**WEBSITE** [f45training.sg/farrerpark/home](http://f45training.sg/farrerpark/home)

2100m

## Golden Mile Complex

\$

Singapore's own little Thailand can be found at this complex offering multiple authentic Thai eateries. The only thing missing are the amazing night markets found beside the malls. Other than that, be prepared to feel like you've stepped into the land of smiles!

---

**ADDRESS** 5001 Beach Rd  
Singapore 199588

---

**OPENING HOURS** Open daily: 9am – 9pm

---

**CONTACT** N/A

---

**WEBSITE** N/A

2000m

## The Projector

\$

Enjoy old school theatres with those huge projector screens and the prominent red chairs? Well, you're in luck! Bring yourself back in time as you lounge away at the Intermission Bar or catch award-winning films at one of their many unique theatre halls.

---

**ADDRESS** 6001 Beach Road, #05-00  
Golden Mile Tower  
Singapore 199589

---

**OPENING HOURS** Monday to Friday: 4pm – 8.30pm  
Saturday/Sunday/  
Public Holidays: 1pm – 8.30pm

---

**CONTACT** info@theprojector.sg

---

**WEBSITE** theprojector.sg/



# culture pushers

Appreciate the finer things in life? Wander down vibrant alleyways to the city's coolest spots — from landmarks of national significance to homegrown businesses, get to know the lesser-known stories of Singapore!

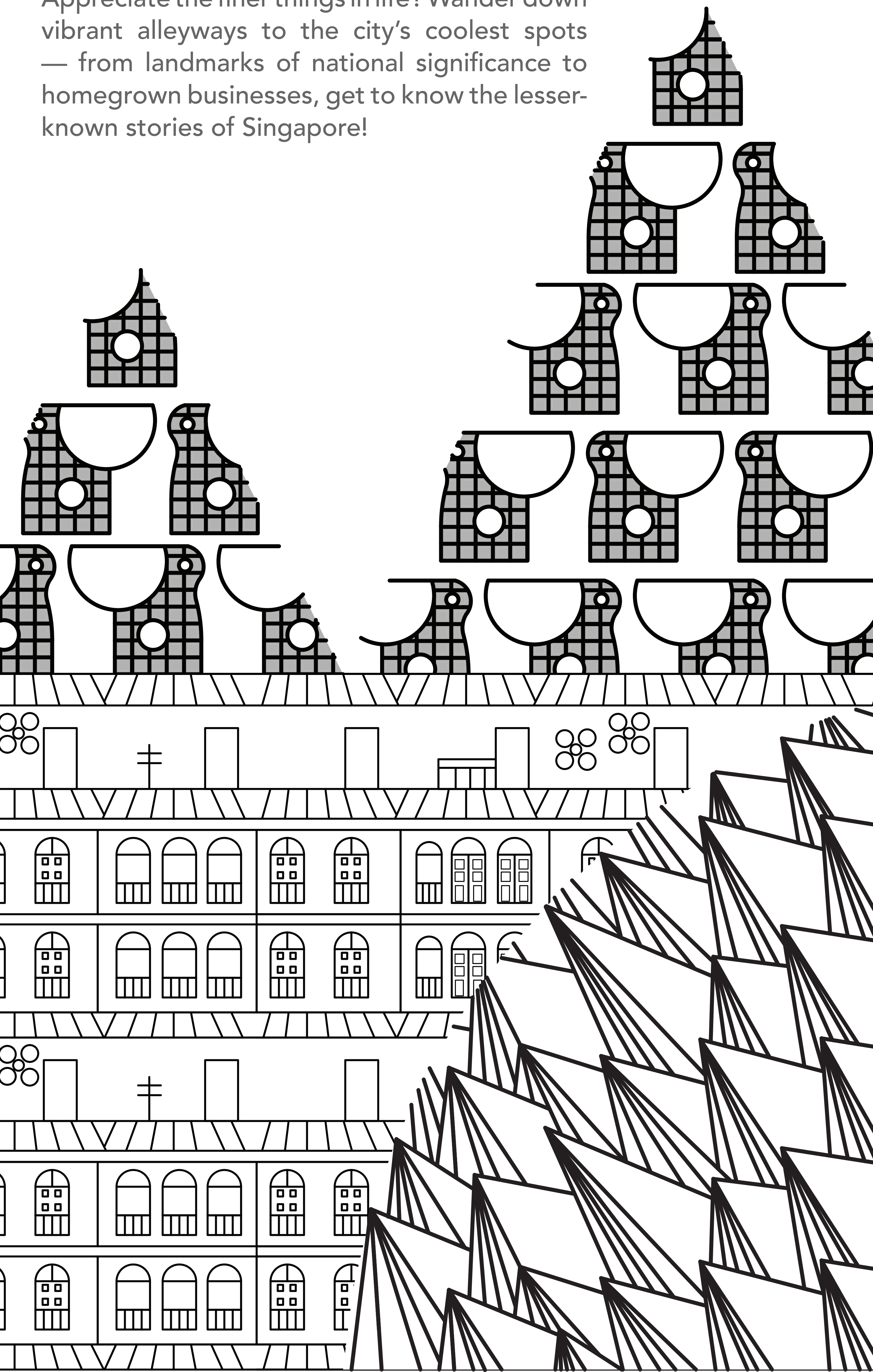

400m

## Fade Avenue

\$

To the lads out there wanting a fresh gentlemen's cut that make your bros go "I like ya cut G!", look no further as Fade Avenue is right around the block and ready to give you the freshest fade in town.

---

**ADDRESS** 462 Serangoon Rd  
Singapore 218141

---

**OPENING HOURS** Open daily: 9am – 9pm

---

**CONTACT** 8879 1257

---

**WEBSITE** [fadeavenue.com/](http://fadeavenue.com/)

280m

## Malayan Leather Craft

\$

Enjoy bespoke leather goods? Malayan Leather Craft has got you covered. Nothing feels better than having a well-crafted leather piece that you can call your own.

---

**ADDRESS** 685 Race Course Rd, #01-336  
Singapore 210685

---

**OPENING HOURS** Tuesday to Saturday: 12pm – 7pm  
Sunday: 12pm – 5pm  
Monday: Closed

---

**CONTACT** 9297 2313

---

**WEBSITE** [www.facebook.com/malayantraders/](http://www.facebook.com/malayantraders/)

210m

## Heap Hong & Co

\$

Blend in with the locals. Visit an old school Singaporean bicycle shop – one that you can certainly find at some of the older neighbourhoods. Take a ride around the city by visiting the folks here at Heap Hong & Co!

---

**ADDRESS** 683 Tessensohn Rd, #01-113  
Singapore 210683

---

**OPENING HOURS** Monday to Saturday: 12pm – 7pm  
Sunday: Closed

---

**CONTACT** 6293 1286

---

**WEBSITE** N/A

950m

## Loop Garms

\$

Popular for their loud pieces, there is a unique history behind each item sold at this boutique vintage shop. Loop Garms takes you on a walk down memory lane - back to the '90s where pop culture was flourishing!

---

**ADDRESS** 635 Veerasamy Road, #01-148  
Singapore 200635

---

**OPENING HOURS** Friday to Sunday: 12pm – 7.30pm  
Monday to Thursday: Closed

---

**CONTACT** N/A

---

**WEBSITE** [www.facebook.com/loopgarms/](https://www.facebook.com/loopgarms/)  
[www.instagram.com/loopgarms/](https://www.instagram.com/loopgarms/)

1000m

## Indian Heritage Centre

\$

Immerse yourself in the culture, heritage and history of the Indian community. This 3,090 square meter enclave houses their rich and vibrant history to promote awareness for a deeper appreciation of their culture.

---

**ADDRESS**

5 Campbell Lane  
Singapore 209924

---

**OPENING HOURS**

Tuesday to Thursday: 10am – 7pm  
Friday and Saturday: 10am – 8pm  
Sunday: 10am – 4pm  
Monday: Closed

---

**CONTACT**

6291 1601

---

**WEBSITE**

[www.indianheritage.gov.sg](http://www.indianheritage.gov.sg)

1000m

## Former House of Tan Teng Niah

\$

This picturesque Chinese Villa is a unique architectural gem; colourful and vibrant, syncing perfectly with the vibes of the Farrer Park vicinity.

---

**ADDRESS**

37 Kerbau Rd  
Singapore 219168

---

**OPENING HOURS**

Open daily: 24 hours

---

**CONTACT**

[www.roots.gov.sg/contact-us](http://www.roots.gov.sg/contact-us)

---

**WEBSITE**

[www.roots.gov.sg](http://www.roots.gov.sg)

1000m

## Tekka Centre

\$

Tekka Centre is a wet market, a food centre and is also home to many ethnic shops with rich Indian heritage encompassing the entire vicinity. Visit the iconic landmark and immerse yourself in the buzz of the Farrer Park community.

---

**ADDRESS** 665 Buffalo Road  
Singapore 210665

---

**OPENING HOURS** Tuesday to Friday: 5am – 1pm  
Saturday and Sunday: 5am – 12pm  
Monday: Closed

---

**CONTACT** N/A

---

**WEBSITE** N/A

950m

## Haniffa Pte Ltd

\$\$

Looking for a nicely fitted *sari* or *choli* to impress for an occasion, or *pattu langa* for your kids? Haniffa Textiles has got you covered! Be spoilt for choice as you pick from an array of textiles in vivid colours.

---

**ADDRESS** 60 Serangoon Road  
Singapore 217967

---

**OPENING HOURS** Open daily: 10.30am – 9.30pm

---

**CONTACT** 6392 7655

---

**WEBSITE** [www.haniffa.com.sg](http://www.haniffa.com.sg)

750m

# Sri Veeramakaliamman Temple

FREE!

Take a short 9-minute stroll to the nearby Hindu temple and be one with your spiritual side. The temple also offers a scenic sight amidst the bustling streets of Serangoon Road and is famed for its intricate architecture.

---

**ADDRESS**

141 Serangoon Rd  
Singapore 218042

---

**OPENING HOURS**

Open daily: 8am – 12pm  
6.30pm – 9pm

---

**CONTACT**

6293 4634

---

**WEBSITE**

<http://srivkt.org/>

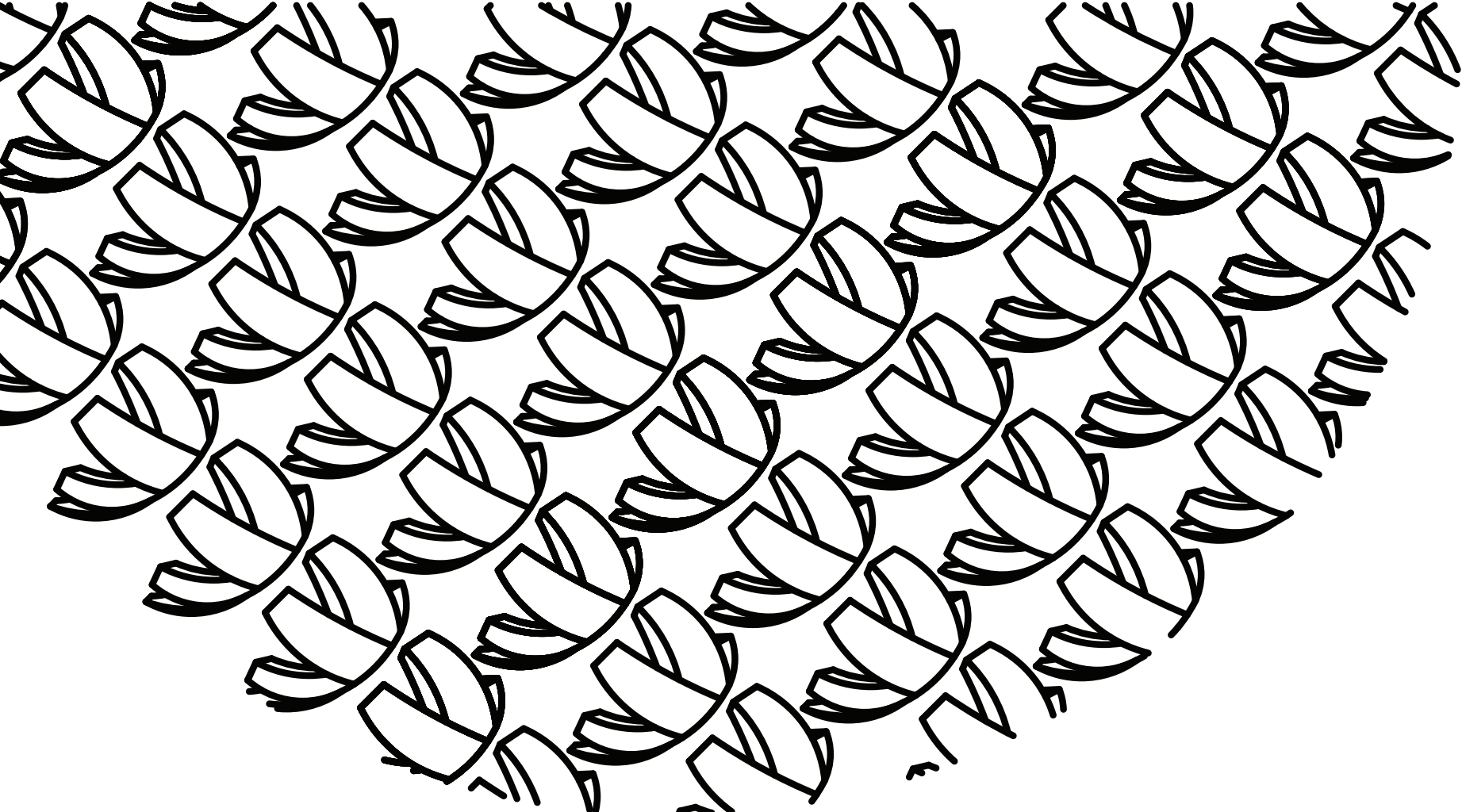

# gastronomers

Already thinking of your next meal? Prove your salt as the ultimate foodie by feasting your way through diverse Singaporean dishes, from the city's iconic hawker centres, to stylish cafés!

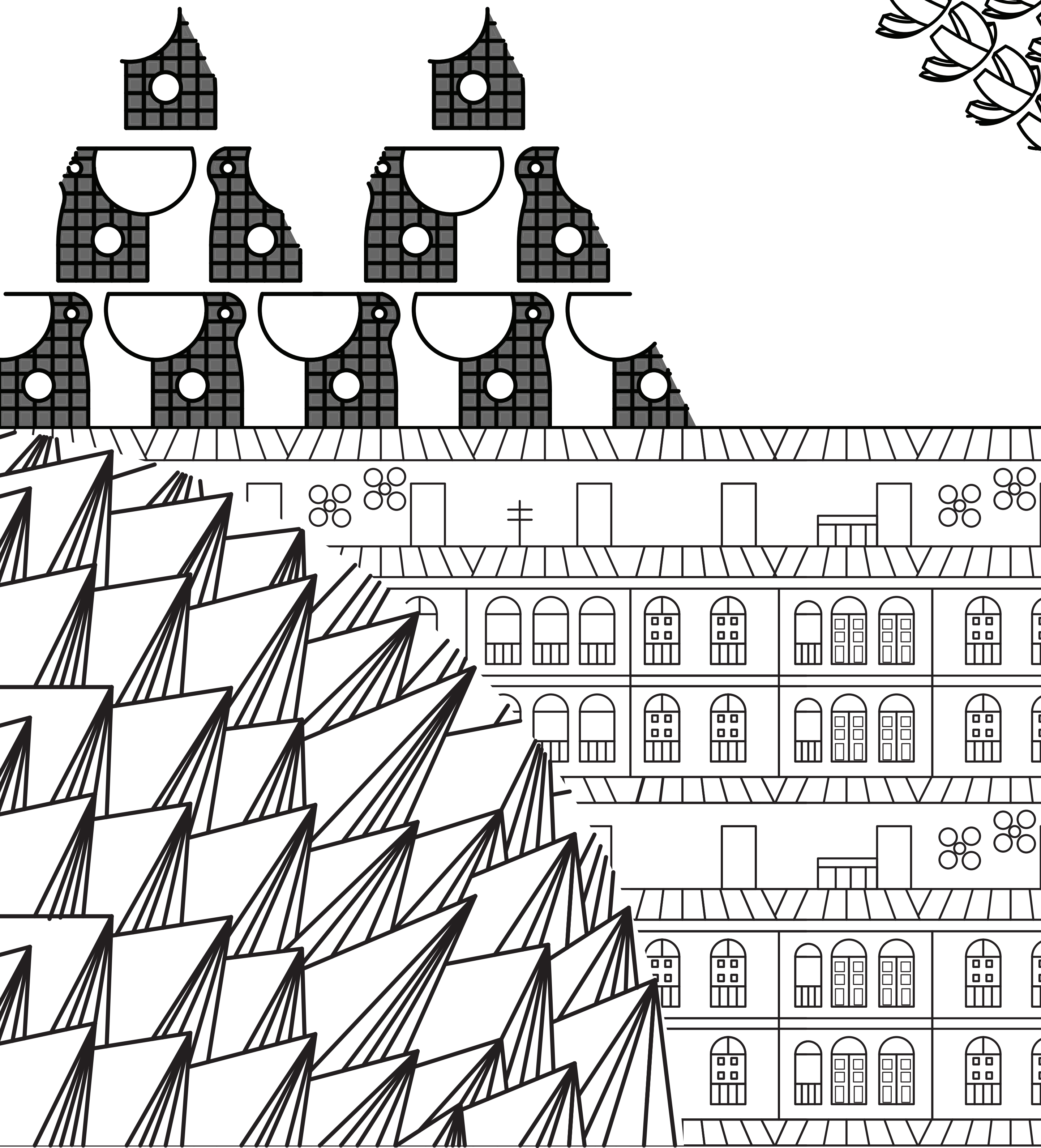

400m

## The Bakehaus

\$

Get baked! Visit this artisanal bakery serving an assortment of fresh bakes and pastries satisfying almost any palate.

**ADDRESS** 130 Owen Rd  
Singapore 218934

**OPENING HOURS** Wednesday to Monday: 8am – 5pm  
Tuesday: Closed

**CONTACT** 6592 7641  
enquiry@thebakehaus.sg

**WEBSITE** [www.thebakehaus.sg](http://www.thebakehaus.sg)

1000m

## Apartment Coffee

\$

Love a good cuppa? Enjoy sippin' on freshly roasted coffee in this beautiful minimalist space with your pals. Whip out your phones and start snapping some shots for Instagram and TikTok!

**ADDRESS** 161 Lavender St, #01-12  
Singapore 338750

**OPENING HOURS** Open Daily: 10am – 6pm

**CONTACT** N/A

**WEBSITE** <https://apartmentcoffee.co/>



450m

## Podi & Poriyal

\$

Love a good authentic South-Indian cuisine? Just right around the corner of Farrer Park, treat yourself to a curated menu of authentic South Indian flavours.

### ADDRESS

486 Serangoon Rd  
Singapore 218151

### OPENING HOURS

Monday and Tuesday: Closed  
Wednesday and  
Thursday: 6pm – 10.30pm  
Friday to Sunday: 12pm – 3pm  
6pm – 10.30pm

### CONTACT

9711 2400

### WEBSITE

[podinandporiyal.com/](http://podinandporiyal.com/)

\$\$

1100m

## MeatSmith Little India

Ever wondered what American barbecue accompanied by Indian spices taste like? Heaven in your mouth. Enjoy Singapore's first Modern Indian Barbecue restaurant located in the heart of Little India.

### ADDRESS

21 Campbell Lane  
Singapore 209894

### OPENING HOURS

Tuesday to Sunday: 11.30am – 11.45pm  
Monday: Closed

### CONTACT

9625 9056

### WEBSITE

<https://www.meatSmith.com.sg>

700m

## Ponggol Nasi Lemak – Jalan Besar

\$

Have you ever wondered how Singaporeans like their rice? Having a rich plate of Nasi Lemak has to be one of the top favourites – especially Ponggol Nasi Lemak's version. Sprinkle all that *Ikan Bilis* and enjoy the burn of the sweet spicy chilli atop the heavenly scented coconut rice.

---

**ADDRESS**

371 Jalan Besar, #01-01  
Singapore 208998

---

**OPENING HOURS**

Friday to Wednesday: 11.30am – 10pm  
Thursday: Closed

---

**CONTACT**

6293 0020

---

**WEBSITE**

[www.ponggolnasilemak.com.sg](http://www.ponggolnasilemak.com.sg)

1000m

## Wimbly Lu @ Tyrwhitt Road

\$

Beat the heat! Get out from the scorching sun and enjoy a nice serving of ice cream and waffles with your pals! Wimbly Lu is sure to cool you off on a typical summer day in Singapore.

---

**ADDRESS**

166 Tyrwhitt Rd  
Singapore 207570

---

**OPENING HOURS**

Tuesday: Closed  
Wednesday to Monday: 11am – 10pm

---

**CONTACT**

6291 8138

---

**WEBSITE**

[www.wimblylu.com](http://www.wimblylu.com)

900m

## Chye Seng Huat Hardware

\$

Don't get mistaken over the word "hardware"! This space doubles up as a cozy cafe right around the corner of King George's, serving up an array of delightful brunch mains and freshly roasted coffee for the coffee lovers out there. Occasionally, the space also hosts their own little party along the streets just to jazz it up a little over the weekends!

---

**ADDRESS**

150 Tyrwhitt Rd  
Singapore 207563

---

**OPENING HOURS**

Open daily: 8.30am – 8pm

---

**CONTACT**

6299 4321

---

**WEBSITE**

[www.cshhcoffee.com/home](http://www.cshhcoffee.com/home)

750m

## Swee Choon Tim Sum

\$

Fulfil those late-night cravings for dim sum as Swee Choon opens till late! Don't forget to try out their famous oozing xiao long baos! You will be surprised at the number of locals dining here even in the wee hours of 2am.

---

**ADDRESS**

183/185/187/189, 191/193, Jalan Besar  
Singapore 208882

---

**OPENING HOURS**

Monday to Thursday:  
11am – 2.30pm / 6pm – 2am  
Friday: 11am – 2.30pm / 6pm – 3am  
Saturday: 10am – 3.30pm / 6pm – 3am  
Sunday: 10am – 3.30pm / 6pm – 2am

---

**CONTACT**

6225 7788

---

**WEBSITE**

[www.sweechoon.com](http://www.sweechoon.com)

850m

## The Banana Leaf Apolo

\$\$

Enjoy the uniqueness of having a delicious meal over a fresh and clean banana leaf which makes you feel like you've been transported to India! Try out their famous Apolo Fish Head Curry and be left in awe with your taste buds awakened by the fresh spices used in their curry.

---

**ADDRESS**

54 Race Course Road  
Singapore 218564

---

**OPENING HOURS**

Open daily: 10.30am – 10.30pm

---

**CONTACT**

6293 8662  
enquiry@thebananaleafapolo.com

---

**WEBSITE**

[www.thebananaleafapolo.com](http://www.thebananaleafapolo.com)

350m

## MTR Singapore

\$\$

Better known as MTR back in India, the establishment started in 1924 in Bangalore and is one of the leading heritage restaurants. Get ready to taste some delicious, authentic and traditional South Indian cuisines which will warm your heart.

---

**ADDRESS**

440 Serangoon Road  
Singapore 218134

---

**OPENING HOURS**

Tuesday to Sunday: 8.30am – 3pm  
5.30pm – 9.30pm  
Monday: Closed

---

**CONTACT**

6296 5800

---

**WEBSITE**

[www.mtrsingapore.com](http://www.mtrsingapore.com)

**lyf Farrer Park Singapore**  
**2 Perumal Road, #01-01**  
**Singapore 218773**

**+(65) 6513 1788**

**#livelyfhere**

**f live.lyf.here**

**@ live.lyf.here**

**www.discoverasr.com**